

BATTERIES & CHARGERS

The battery pack is not fully charged out of the carton. Before using the battery pack and charger, read the safety instructions in the Safe Operation Practices section and then follow charging procedures outlined in this section. When ordering replacement battery packs, be sure to include the catalog number and voltage.

Important Charging Notes

- Longest life and best performance can be obtained if the battery pack is charged when the air temperature is between (65° F - 75° F (18° C - 24° C)). DO NOT charge when the battery pack is below +40° F (+4.5° C), or above +104° F (+40° C). This is important and will prevent serious damage to the battery pack.
- The charger and battery pack may become warm to the touch while charging. This is a normal condition, and does not indicate a problem. To facilitate the cooling of the battery pack after use, avoid placing the charger or battery pack in a warm environment such as in a metal shed or an uninsulated trailer.
- If the battery pack does not charge properly:
 - Check operation of receptacle by plugging in a lamp or other appliance;
 - Check to see if receptacle is connected to a light switch which turns power off when you turn out the lights;
 - Move the charger and battery pack to a location where the surrounding air temperature is approximately 65° F - 75° F (18° C - 24° C);
 - If charging problems persist, take the tool, battery pack and charger to your local service center.
- The battery pack should be recharged when it fails to produce sufficient power on jobs which were easily done previously. Do not CONTINUE to use under these conditions. Follow the charging procedure. You may also charge a partially used pack whenever you desire with no adverse effect on the battery pack.
- Foreign materials of a conductive nature such as, but not limited to, grinding dust, metal chips, steel wool, aluminum foil or any buildup of metallic particles should be kept away from charger cavities. Always unplug the charger from the power supply when there is no battery pack in the cavity. Unplug the charger before attempting to clean.
- Do not freeze or immerse the charger in water or any other liquid.

Charging a Battery

NOTE: Use battery charger CC602 ONLY to charge the batteries used with this mower.

NOTE: To ensure maximum performance and life of lithium-ion battery packs, charge the battery pack fully before first use.

- Plug the charger into an appropriate outlet before inserting battery pack.
- Connect the charger and battery pack (Figure 1), making sure the battery is fully seated. The (charging) light will blink continuously indicating that the charging process has started.

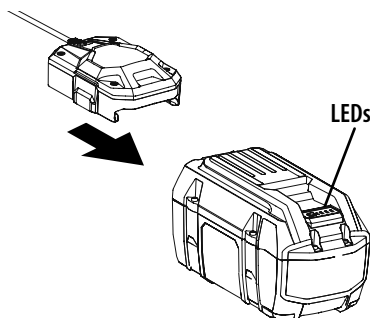

Figure 1

- The completion of charge will be indicated by the light remaining ON continuously. The battery pack is fully charged and may be removed and used at this time or left in the charger.

NOTE: To remove the battery pack, some chargers require the battery pack release button to be pressed.

Indicators		
	Charging	
	Fully Charged	
	Hot/Cold Pack Delay	

A charger will not charge a faulty battery pack. The charger refusing to light could indicate a problem with the charger.

NOTE: If the charger refuses to light, take the charger and battery pack to be tested at an authorized service center.

HOT/COLD PACK DELAY

When the charger detects a battery pack that is too hot or too cold, it automatically starts a Hot/Cold Pack Delay, suspending charging until the battery pack has reached an appropriate temperature. The charger then automatically switches to the pack charging mode. This feature ensures maximum battery pack life.

A cold battery pack may charge at a slower rate than a warm battery pack.

BATTERIES & CHARGERS

Battery and Battery Charger Care

STORAGE RECOMMENDATIONS

1. The best storage place is one that is cool and dry, away from direct sunlight and excess heat or cold.
2. For long storage, it is recommended to store a fully charged battery pack in a cool dry place out of the charger for optimal results.

NOTE: Battery packs should not be stored completely depleted of charge. The battery pack will need to be recharged before use.

BATTERY PACK CLEANING INSTRUCTIONS

Dirt and grease may be removed from the exterior of the battery using a cloth or soft non-metallic brush. Do not use water or any cleaning solutions.

CHARGER CLEANING INSTRUCTIONS

⚠ WARNING

Shock hazard. Disconnect the charger from the AC outlet before cleaning. Dirt and grease may be removed from the exterior of the charger using a cloth or soft non-metallic brush. Do not use water or any cleaning solutions.

1. Keep the battery charger clean and clear of debris. Do not allow foreign material into the charger connector (a) or onto the terminals (b) (Figure 2). Inspect the battery charger for foreign material before each use.

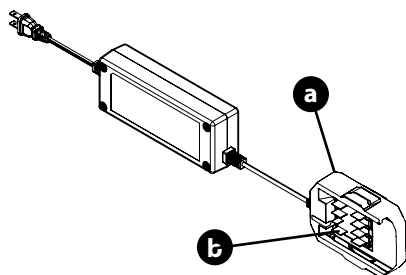

Figure 2

2. Make sure the charger has not been shorted by debris. Inspect the terminals for soot and signs of melting. Do not attempt to use a damaged charger.

Transportation

⚠ WARNING

Fire hazard. Do not store or carry the battery pack so that metal objects can contact exposed battery terminals. For example, do not place the battery pack in aprons, pockets, tool boxes, product kit boxes, drawers, etc., with loose nails, screws, keys, etc. Transporting batteries can possibly cause fires if the battery terminals inadvertently come in contact with conductive materials such as keys, coins, hand tools and the like. The US Department of Transportation Hazardous Material Regulations (HMR) actually prohibit transporting batteries in commerce or on airplanes in carry-on baggage UNLESS they are properly protected from short circuits. When transporting individual battery packs, make sure that the battery terminals are protected and well-insulated from materials that could contact them and cause a short circuit.

NOTE: Li-ion batteries should not be put in checked baggage.

ASSEMBLY AND SET-UP

NOTE: Reference to right and left hand side of the Lawn Mower is observed from the operating position.

Unpacking

OPENING CARTON

1. Cut each corner of the carton vertically from top to bottom.
2. Remove all loose parts:
 - Grass Catcher (if equipped)
 - Battery (if equipped)
 - Battery Charger (if equipped)
3. Remove loose packing material.

REMOVING MOWER FROM CARTON

1. Lift mower from the rear to detach it from underlying carton material and roll mower out of carton.
2. Check carton thoroughly for any other loose parts.
3. Remove any packing material which may be between upper and lower handles.

Assembly

CHARGE BATTERIES

1. Charge battery. Refer to Charging a Battery on page 9.

HANDLE ASSEMBLY

1. Loosen the wing knob securing the left side upper and lower handle together shown in Figure 3 inset.
2. Remove the packaging with wing knob and bolt Securing the right side upper and lower handles together.
3. Gently lift and pivot the upper handle into the position shown in Figure 3.

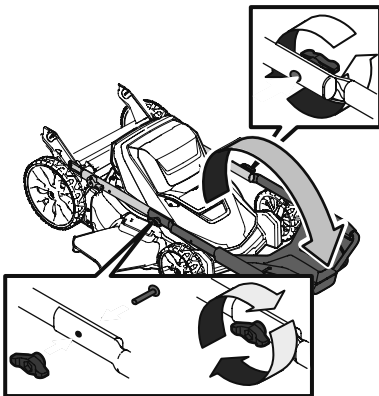

Figure 3

4. Insert bolt through the right side lower and upper handle. Thread wing knob onto bolt. See Figure 3 inset.

5. Securely tighten the wing knobs to secure the upper handle to the lower handle.
6. Rotate the handle adjustment levers to release the handle adjustment pins from the handle bracket. See Figure 4 insets.

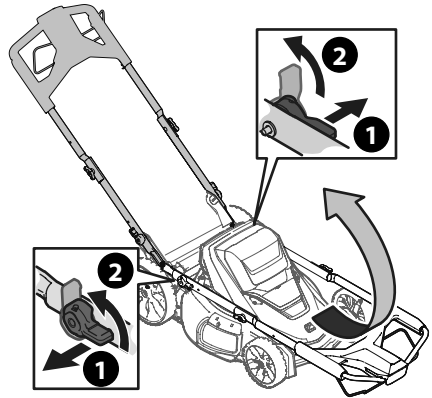

Figure 4

7. Carefully lift the handle up.
8. Place the handle into one of the three handle height positions, high (a), medium (b) or low (c), located on the handle brackets (Figure 5).

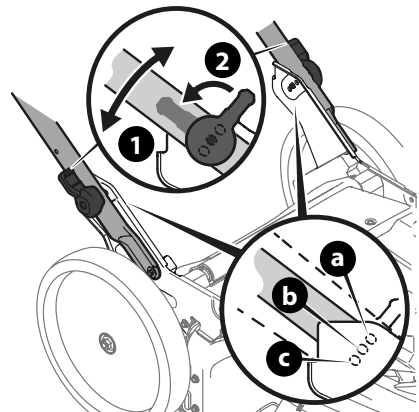

Figure 5

9. Rotate the handle adjustment levers until they are parallel with the handle to lock the pins into one of the handle height positions in the handle brackets (Figure 5).

ASSEMBLY AND SET-UP

GRASS CATCHER ASSEMBLY

1. Follow steps below to assemble the grass catcher (if needed). Make certain bag is turned right side out before assembling (warning label will be on the outside) (Figure 6).
 - A. Place bag over frame so that its black plastic side is at the bottom.
 - B. Slip plastic channel of grass bag over hooks on the frame.

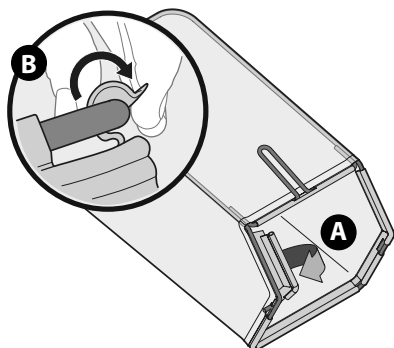

Figure 6

Set-Up

CHECKING THE BATTERY CHARGE LEVEL

Press the charge meter button on the battery (Figure 7). The number of lights that illuminate will indicate the current charge level of the battery. If all three lights are dark, charge the battery before any further use. Refer to Charging a Battery on page 9.

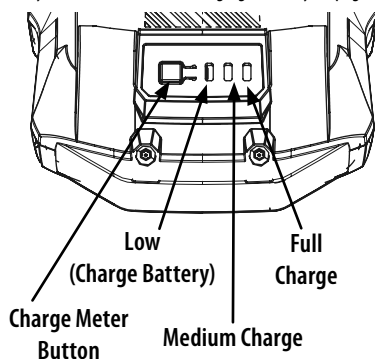

Figure 7

NOTE: While in use, lithium-ion batteries provide power with minimal power fade. When the battery is fully discharged, it will immediately cut power to the mower and require charging.

⚠ WARNING

Do not expose the mower to rain or wet conditions.

GRASS CATCHER

1. Lift mower rear discharge door. (Figure 8).
2. Place grass catcher into the slots in the handle brackets. Release discharge door so that it rests on the grass catcher.

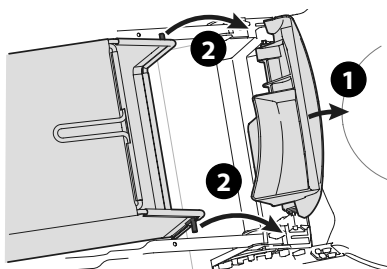

Figure 8

To remove grass catcher, lift mower rear discharge door. Lift grass catcher up and off the slots in the handle brackets. Release mower rear discharge door to allow it to close.

SIDE DISCHARGE CHUTE/MULCH PLUG

Your mower was shipped as a mulcher. To convert to side discharge, make sure grass catcher is not installed and rear discharge door is closed.

1. On the right side of the mower, lift the mulch plug (Figure 9).

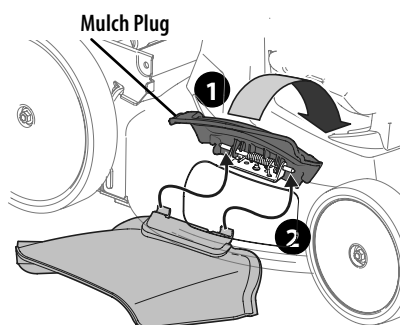

Figure 9

2. Slide two hooks of side discharge chute under hinge pin on mulch plug assembly. Lower the mulch plug.

IMPORTANT: Do not remove mulch plug at any time.

To remove side discharge chute, lift the mulch plug. Lift the side discharge chute up to release the slide hooks from under the mulch plug hinge pin. Release mulch plug to allow it to close.

ASSEMBLY AND SET-UP

CUTTING HEIGHT

The cutting height adjustment lever is located above the front and rear left wheel.

1. Pull the cutting height adjustment lever towards wheel.
2. Move lever to desired position for a change in cutting height (Figure 10).

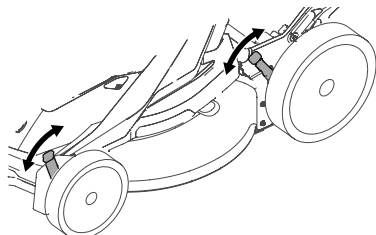

Figure 10

IMPORTANT: Both the front and rear wheels must be placed in the same relative position. For rough or uneven lawns, move the height adjustment levers to a higher position. This will stop scalping of grass.

3. Release lever towards deck.

WARNING

Do not at any time make any adjustment to lawn mower without first stopping motor and removing push start safety key.

INSTALLING BATTERY

IMPORTANT: Use only with series CC6050 or CC6025 batteries.

1. Lift up the battery housing lid.
2. Slide one battery (a) into right side battery port (b) (as standing in front of mower) so that the battery indicator light faces up from the battery port (Figure 11).
3. Push the battery firmly until the battery locks into place. There should be an audible “click” when the battery is in position.

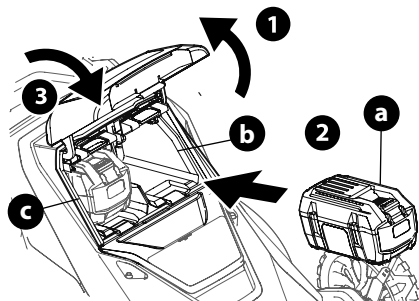

Figure 11

4. Repeat STEPS 2 and 3 to install a second battery (available separately) into the left side battery storage port (c).

NOTE: Left side battery storage port is for storing a second battery. This port is not used to power the mower.

5. Close battery housing lid.