

Thank You

Thank you for purchasing this product. It was carefully engineered to provide excellent performance when properly operated and maintained.

Please read this entire manual prior to operating the equipment. It instructs you how to safely and easily set up, operate and maintain your machine. Please be sure that you, and any other persons who will operate the machine, carefully follow the recommended safety practices at all times. Failure to do so could result in personal injury or property damage.

All information in this manual is relative to the most recent product information available at the time. Review this manual frequently to familiarize yourself with the machine, its features and operation. Please be aware that this Operator's Manual may cover a range of product specifications for various models. Characteristics and features discussed and/or illustrated in this manual may not be applicable to all models. We reserve the right to change product specifications, designs and equipment without notice and without incurring obligation.

If applicable, the power testing information used to establish the power rating of the engine equipped on this machine can be found at www.opei.org or the engine manufacturer's web site.

If you have any problems or questions concerning the machine, phone your local authorized service dealer or contact us directly. We want to ensure your complete satisfaction at all times.

Throughout this manual, all references to *right* and *left* side of the machine are observed from the operating position.

Contents of Crate

- | | | |
|-------------------------|--|--------------------------------|
| • Zero-Turn Tractor (1) | • Operator's Manual (1) | • Engine Operator's Manual (1) |
| • Oil Drain Tube (1) | • Deck Wash Hose Coupler (1) (If equipped) | • Hardware Pack (1) |

Note: This Operator's Manual covers several models. Tractor features may vary by model. Not all features in this manual are applicable to all tractor models and the tractor depicted may differ from yours.

Note: All references in this manual to the left or right side and front or back of the tractor are from the operating position only. Exceptions, if any, will be specified.

Tractor Preparation

1. Remove the upper crating material from the shipping pallet, and cut any bands or tie straps securing the tractor to the pallet.
2. If the deck is not in the highest mowing position (pulled all the way back), use the deck lift handle to raise the deck to its highest position. Refer to the Controls & Operation section for instructions on raising and lowering the deck.
3. Disengage the parking brake.
4. Engage the transmission bypass rods on each side of the tractor; then carefully roll the tractor off the shipping pallet. The transmission bypass rods (one for each, RH and LH transmission) are located on the rear of the tractor, just inside each rear wheel. Engage the bypass rods by pulling each one out and to the right then letting it return to lock it into place. See Figure 2-1.

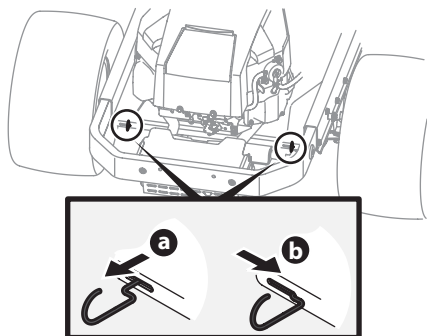

Figure 2-1

5. Disengage the bypass rods after rolling the tractor off the pallet. See Figure 2-1.

6. If equipped, remove the deck wash system nozzle adapter from the manual bag and store for future use.

Securing the Steering Column (Non-Tilt Tractors)

The steering column is tilted all the way back for shipping. Place the steering column in one of the two positions and secure in place with the hex screws (a) and flat washers (b) packed separately. See Figure 2-2.

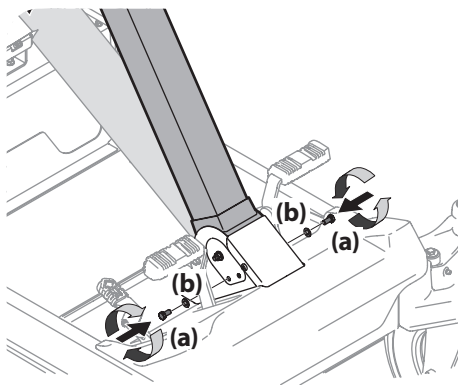

Figure 2-2

Securing the Steering Column (Tractors w/ Tilt Steering)

The steering column is shipped all the way down for shipping.

Remove the shipping screw from the steering column and discard it. See Figure 2-3.

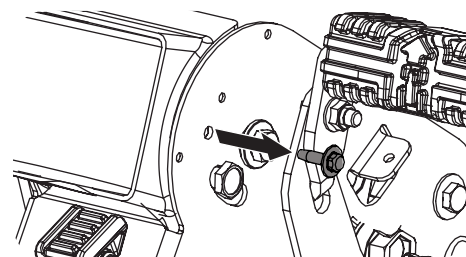

Figure 2-3

Lift the steering column up until it clicks into the lowest tilt position. Then the steering column can be adjusted to the desired height as instructed in the Controls & Operation section.

Installing the Console (If necessary)

1. Connect the headlight harness/12V wiring harness to the main harness. Make sure the D-shape connectors align properly. See Figure 2-4.

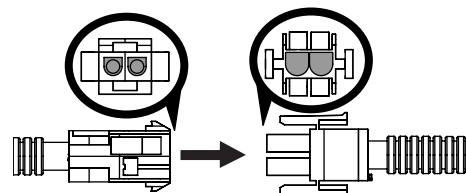

Figure 2-4

- Slide the console onto the steering column with the wiring harness tucked in behind the console. Make sure the lower portion of the console is inside the lower column cover. See Figure 2-5 and Figure 2-6.

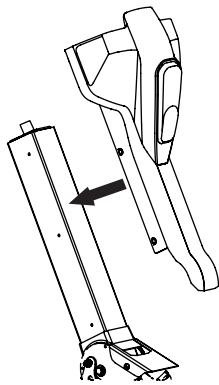

Figure 2-5

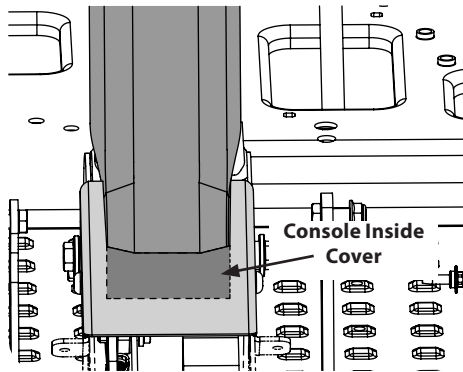

Figure 2-6

- Secure the console in place with the six shoulder screws. See Figure 2-7. Torque the shoulder screws to 60 in/lbs (+/- 20%).

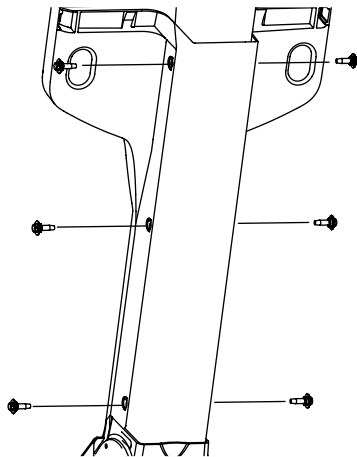

Figure 2-7

Note: Do not overtighten the shoulder screws. Doing so can cause damage to the console.

Steering Wheel (If necessary)

- Remove the hardware for attaching the steering wheel (a) from beneath the steering wheel cover (b). Carefully pry off the steering wheel cover (b) to remove the hardware. See Figure 2-8.

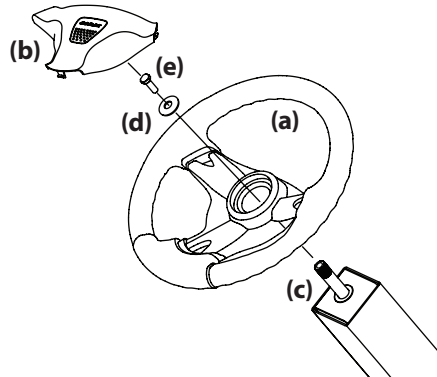

Figure 2-8

- With the wheels of the tractor pointing straight forward, place the steering wheel (a) over the steering shaft (c). See Figure 2-8.
- Place the steering wheel cover (b) over the center of the steering wheel (a) and push downward until it "clicks" into place. See Figure 2-8.
- Place the steering wheel cover (b) over the center of the steering wheel (a) and push downward until it "clicks" into place. See Figure 2-8.
- Place the steering wheel cover (b) over the center of the steering wheel (a) and push downward until it "clicks" into place. See Figure 2-8.

Install Operator's Seat

Seat Pan attached to Seat

To install the seat proceed as follows:

- Cut any straps securing the seat assembly to the tractor. Remove any packing material.

Note: Be careful not to cut the seat switch wiring harness.

- Remove the two shoulder screws (a) and flange lock nuts (b) in the seat pan as shown in Figure 2-9.

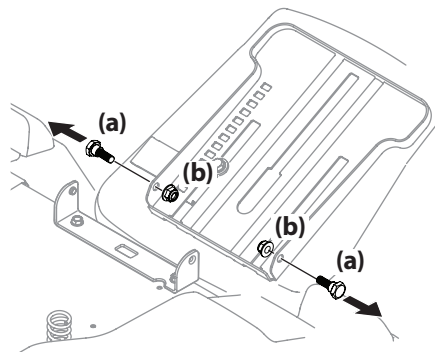

Figure 2-9

- Rotate the seat into position and secure the seat into place with the previously removed shoulder screws (a) and flange lock nuts (b). Be careful not to crimp or damage the wire harness while installing the seat. See Figure 2-10.

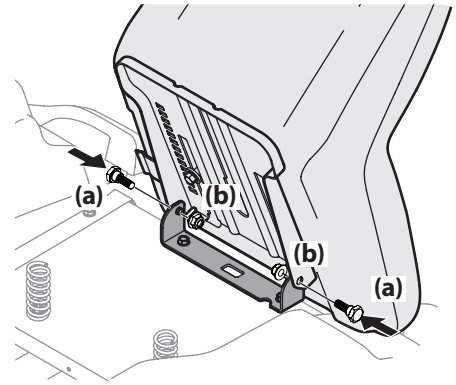

Figure 2-10

- If necessary, securely connect the seat switch wiring harness (a) to the seat switch (b) as shown in Figure 2-11. Be sure to push the excess wire from the wire harness into the seat box hole (c) before continuing.

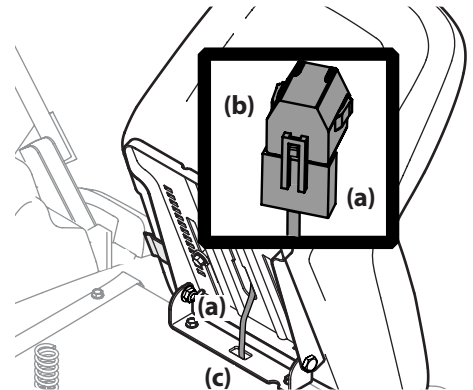

Figure 2-11

Note: The tractor will not operate without the seat switch wiring harness in place.

Seat Pan attached to Tractor

To install the seat proceed as follows:

- Cut any straps securing the seat assembly to the tractor. Remove any packing material.

Note: Be careful not to cut the seat wiring harness.

- Using the four provided bolts (a), install the seat onto the seat pan. Place the screws (b) on the front of the seat through the middle hole in the seat pan (c) as shown in Figure 2-12. Securely tighten the seat to the seat pan.

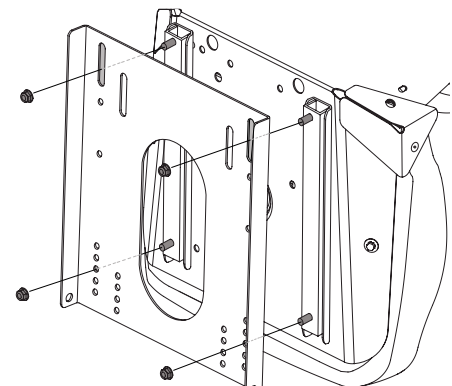

Figure 2-12

3. If necessary, securely connect the seat switch wiring harness (a) to the seat switch (b) as shown in Figure 2-13. Be sure to push the excess wire from the wire harness into the seat box hole (c) before continuing.

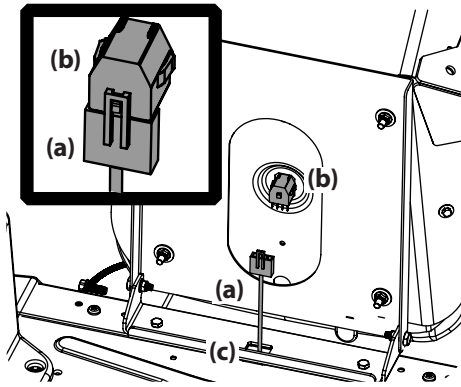

Figure 2-13

Note: The tractor will not operate without the seat switch wiring harness in place.

Lower Deck Discharge Chute Deflector

⚠ WARNING

Never operate the mower deck without the chute deflector installed and in the down position.

Note: For models with 46", 50" and 54" decks skip ahead to step 6.

1. Remove the keys that are attached with a zip tie to the chute bracket.
2. Remove the flange lock nut and hex screw from the deck.
3. Place the chute deflector on the deck, be sure to insert the tabs on the chute deflector into the holes on the deck. See Figure 2-14.

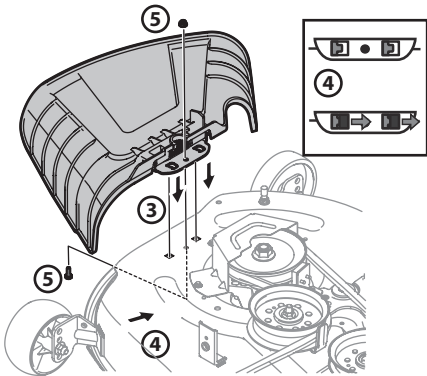

Figure 2-14

4. When the tabs are installed in the deck, slide the chute deflector toward the rear of the tractor until the bolt hole in the chute deflector aligns with the hole in the deck. See Figure 2-14.

5. Secure the chute deflector in place with the flange lock nut and hex screw removed in step 2. Tighten to 102-124 in-lbs. See Figure 2-14.
6. On models with 46", 50" and 54" decks the chute is shipped attached and with a stop bracket holding the chute upright. The stop brackets must be removed prior to operating the tractor.
7. Holding the chute deflector fully upward, remove the shipping brace. Lower the chute deflector and discard the shipping brace. See Figure 2-15.

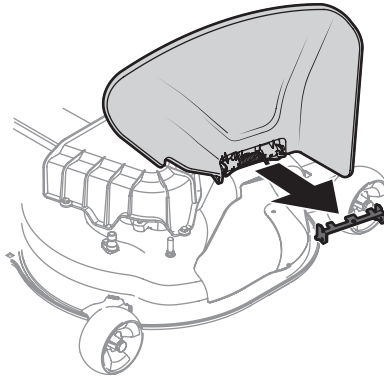

Figure 2-15

Setting the Front Gauge Wheels

⚠ WARNING

Keep hands and feet away from the discharge opening of the cutting deck.

Note: The deck wheels are an anti-scalp feature of the deck and are not designed to support the weight of the cutting deck.

Move the tractor on a firm and level surface, preferably pavement, and proceed as follows:

1. Check the tire pressure, make sure the pressure is correct and equal on all tires.
2. Make sure the deck is level, both front-to-back and side-to-side. See the Product Care section for deck leveling information and instructions.
3. Select the height position of the cutting deck by placing the deck lift lever in the normally desired mowing height setting.
4. Check the wheels for contact or excessive clearance with the surface below. The deck wheels should have between 1/4" and 1/2" clearance above the ground. Proceed as follows to adjust the wheels:

- a. Remove the lock nut securing one of the front gauge wheel shoulder screws to the deck. Remove the gauge wheel and shoulder screw. See Figure 2-16.

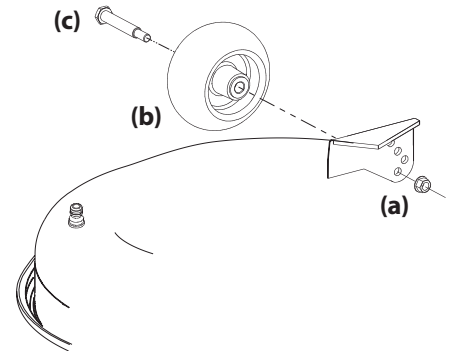

Figure 2-16

- b. Insert the shoulder screw into one of four index holes in the front gauge wheel bracket that will give the gauge wheel a 1/4-1/2" clearance with the ground.
- c. Note the index hole of the just adjusted wheel, and adjust the other front gauge wheel into the respective index hole of the other front gauge wheel bracket.

Note: Refer to Adjustments in the Product Care section of this manual for more detailed instructions regarding various deck adjustments.

Connecting the Battery Cables

⚠ WARNING

California **PROPOSITION 65 WARNING:** Battery posts, terminals, and related accessories contain lead and lead compounds, chemicals known to the State of California to cause cancer and reproductive harm. Wash hands after handling.

⚠ CAUTION

When attaching battery cables, always connect the **POSITIVE (Red)** wire to its terminal first, followed by the **NEGATIVE (Black)** wire.

For shipping reasons, both battery cables on your equipment may have been left disconnected from the terminals at the factory. To connect the battery cables, proceed as follows:

Note: The positive battery terminal is marked Pos. (+). The negative battery terminal is marked Neg. (-).

1. Remove the plastic cover, if present, from the positive battery terminal and attach the red cable to the positive battery terminal (+) with the bolt (a) and hex nut (b). See Figure 2-17.

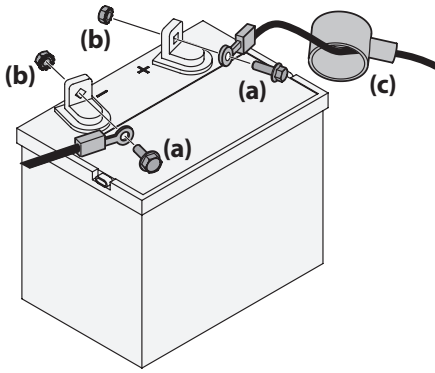

Figure 2-17

2. Remove the plastic cover, if present, from the negative battery terminal and attach the black cable to the negative battery terminal (-) with the bolt (a) and hex nut (b). See Figure 2-17.
3. Position the red rubber boot (c) over the positive battery terminal to help protect it from corrosion.

Note: If the battery is put into service after the date shown on top/side of battery, charge the battery as instructed in the Product Care section prior to operating the tractor.

Adjusting the Seat

There are three seat adjustment methods, proceed with the instructions for your applicable model.

Front Lever Adjust

To adjust the position of the seat, push left and hold the seat adjustment lever. Slide the seat forward or rearward to the desired position; then release the adjustment lever. Make sure seat is locked into position before operating the tractor. See Figure 2-18.

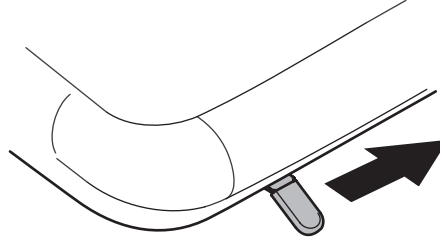

Figure 2-18

Side Lever Adjust

To adjust the position of the seat, pull up and hold the seat adjustment lever. Slide the seat forward or rearward to the desired position; then release the adjustment lever. Make sure seat is locked into position before operating the tractor. See Figure 2-19.

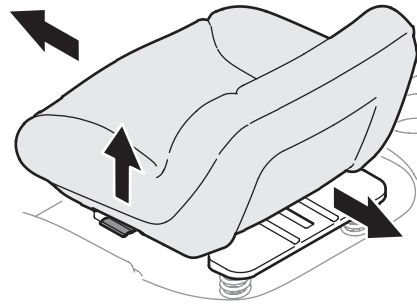

Figure 2-19

Knob Adjust

To adjust the position of the seat, rotate the seat forward and locate the clamp knobs (a) on the front of the seat pan. See Figure 2-20.

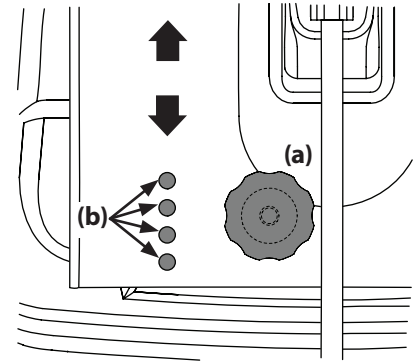

Figure 2-20

Rotate the clamp knobs (a) to the left and remove them, slide the seat forward or backward and re-insert the clamp knobs (a) into one of the four available positions (b) on the seat pan and into the seat, then tighten both securely. Make sure the seat is locked into position before operating the tractor. See Figure 2-20.

Fuel Fill-Up

Using a good grade of unleaded regular gasoline, fill the tank (beside the engine on the left side of the tractor). When the fuel tank reaches one inch from the top of the tank, stop, DO NOT OVERFILL. Space must be left for expansion.

Notes